

FLOAT VALVES

Gadren - Gade™ Valves

Heavy Duty for Industrial and Commercial Use

FOR USE WHERE RELIABLE LIQUID
LEVEL IS REQUIRED

Gade™ is the trade name of our heavy-duty line of industrial quality float valves.

For reliable control of liquids in open or closed tanks, reservoirs, cooling towers, vats or any application where reliability is a must.

The Gade Valve is mechanically operated by a suitable float that rides on the surface of the controlled liquid.

All Gade Valves are balanced for easy operation at higher pressures. The balanced action also provides easier opening and closing that saves wear and tear on the valve and provides a tight closing seal on the single surface.

Our valves are available in either angle bodied or straight through configuration with either the standard neoprene disc and leather cup or with optional *Teflon*® cup and disc.

Gade Valves are also available in either bronze or type 316 stainless steel in sizes from 1/2" to 3" NPT.

All parts and seals are easily replaceable with parts that are always available. You don't have to worry about your supplier not being there since you are dealing with a company that has been around for over fifty years.

Turn to the following page for the dimensions and specifications for the Gadren Gade Float Valve.

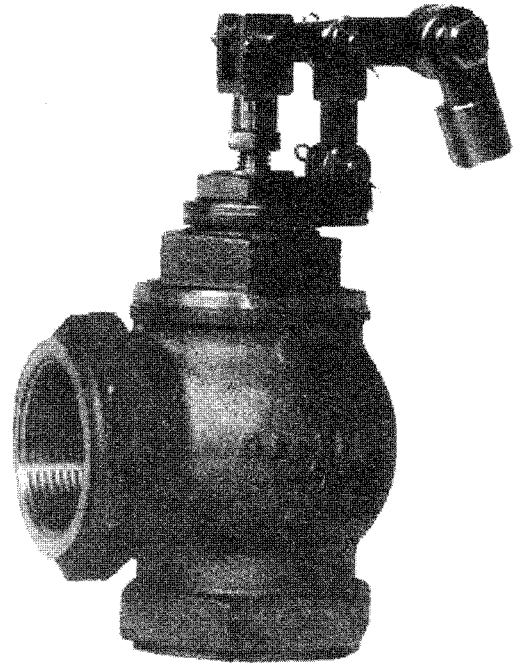

- Sizes 1/2" to 3 NPT
- Available in bronze or 316 stainless steel
- Neoprene disc for up to 180° - *Teflon*® disc for hot water and chemical applications
- Adjustable swivel and float rod level
- Reversible action
- All valves and parts are in stock and available for immediate delivery
- Available with stuffing box for external mounting
- Quick and easy disc and cup replacement
- Balanced action-single seated for tight closing
- American Made



Gade™ Heavy-Duty Industrial Float Valves Dimensions/Specifications

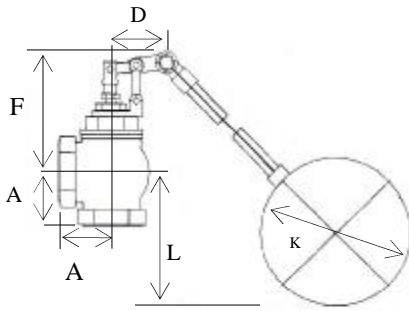

Float valve for open tank service. Angle body shown. Globe straight – through body also available

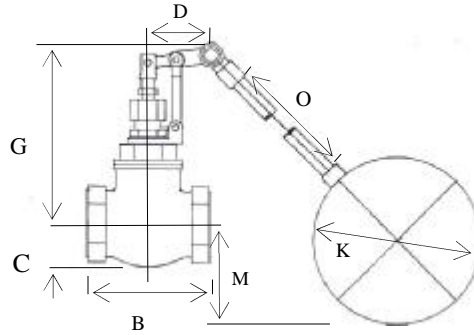

Float Valve with stuffing box for closed tank service or submerged service. Globe straight - through shown . Angle body also available.

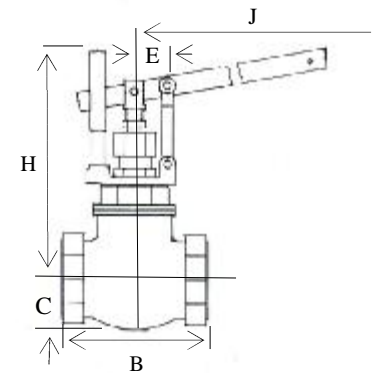

Lever Valve with stuffing box for external or remote operation. Globe straight– through shown. Angle body also available. Optional float and rod available.

Pressure Ratings and Dimensions for Gade Stainless Steel and Bronze Float Valves

Valve Size IPS	Max Inlet Pressure	Float Size	Float Rod Size (NPT)	Dimensions in Inches												
				A	B	C	D	E	F	G	H	J	K	L	M	O
1/2"	100#	5"	1/4" X 16"	1 3/8	2 7/8	13/16	2 1/4	1	4	5 1/2	6	12 1/4	5	11	11	16
3/4"	100#	5"	1/4" X 16"	1 3/8	3	7/8	2 1/4	1	4	5 1/2	6	12 1/4	5	11 1/8	11	16
1"	100#	6"	1/4" X 18"	1 3/4	4	1 3/16	2 1/4	1	4 1/4	6	6 3/8	12 1/4	6	11 1/2	11 1/2	18
1 1/4"	100#	6"	1/4" X 18"	2	4 1/4	1 3/8	2 1/4	1	4 3/4	6 1/2	6 7/8	12 1/4	6	11 3/4	12 1/8	18
1 1/2"	100#	6"	1/4" X 18"	2 1/8	4 1/2	1 1/2	2 1/4	1	5	6 3/4	7 1/8	12 1/4	6	11 1/2	11 7/8	18
2"	75#	8"	3/8" X 20"	2 1/8	5 3/4	2	3 1/4	1 1/2	6	8 3/4	9 3/4	15	8	14	13 1/2	20
3"	75#	8"	3/8" X 24"	3 3/4	8	3	3 1/4	1 1/2	7	9 1/2	11 1/2	15	8	2	19	24

Valve Size	1/2"	3/4"	1"	1 1/4"	1 1/2"	2"	3"
GPM	30	50	75	100	125	175	400

