

ASHCROFT®

Type 1032 Sanitary Pressure Gauge

NOW WITH

PLUS!
Performance

Ashcroft Type 1032 sanitary pressure gauges have specifically been designed to meet the need for sanitary type pressure gauges in the pharmaceutical, biotechnology, filtration and food and dairy markets. With a quick connect clamp and diaphragm surface finish that is electropolished to 12-20RA these instruments are also suitable for use in breweries, wineries and citrus juice production plants. Available in dial sizes from 2" thru 4½" and Tri-Clamp

type connections of ¼" thru 2," Ashcroft's selection of sanitary pressure gauges is unsurpassed.

To meet the needs of the markets served all Ashcroft sanitary gauges, with polysulfone window, can be autoclaved or sterilized to temperatures of 300°F (149°C) and can be cleaned or steamed in place. Ashcroft Type 1032 sanitary gauges with dial sizes of 2½" and 3½" are furnished standard with the patented PowerFlex™ movement. Since the PowerFlex movement is suspended from the Bourdon tube, it resists the effects of pulsation and vibration, one of the primary causes for gauge failure.



ISO 9001
REGISTERED FIRM

DRESSER
Measurement
& Control

BULLETIN SG-2

Ashcroft® Type 1032 sanitary pressure gauges give you all these standard features

- **Plus!** Performance available on 2½", 3½", 4½" gauges, liquid filled performance in a dry case gauge.
- All-welded 316 stainless steel Bourdon tube
- Welded 316L stainless steel diaphragm and seal housing
- USP grade glycerin (99.5% pure, system fill) standard
- 3A compliance to standard 74-00
- 300 series stainless steel case and ring
- Electropolished diaphragm and housing
- Dry and liquid filled gauge versions
- Weatherproof and hermetically sealed versions
- External Easy Zero™ adjust on 3½" dial size



TYPE 1032	2"	2½"	3½"
ACCURACY	3% upscale, up to 5% downscale ⁽³⁾	1.5% F.S. for pressure ranges 100 psi and above. 2.0% F.S. for vacuum, compound and ranges below 100 psi	1.5% F.S. for pressure ranges 100 psi and above. 2.0% F.S. for vacuum, compound and ranges below 100 psi
CASE AND RING MATERIAL	300 series stainless steel	300 series stainless steel	300 series stainless steel
RING TYPE	stainless steel, push-in	bayonet, removable	bayonet, removable
BOURDON TUBE AND SOCKET MATERIAL	316 stainless steel	316 stainless steel	316 stainless steel
DIAPHRAGM MATERIAL AND SURFACE FINISH	316L stainless steel 12 to 20RA	316L stainless steel 12 to 20RA	316L stainless steel 12 to 20RA
PROCESS CONNECTION	¾" Tri-Clamp	1½" or 2" Tri-Clamp	1½" or 2" Tri-Clamp
CONNECTION LOCATION	lower	lower or back	lower or back
SYSTEM FILL	glycerin	glycerin	glycerin
WINDOW MATERIAL	glass	polycarbonate	polycarbonate
POINTER	black painted aluminum non-adjustable	black painted aluminum adjustable	black painted aluminum with external adjust (std.)
DIAL	white with black markings	white with black markings	white with black markings
MOVEMENT	300 series stainless steel	300 series stainless steel	300 series stainless steel
AGENCY APPROVALS	3A compliance ⁽¹⁾	3A compliance ⁽¹⁾	3A compliance ⁽¹⁾
CLEAN OR STEAM IN PLACE (CIP or SIP)	temperature limit of 300°F (149°C)	temperature limit of 300°F (149°C)	temperature limit of 300°F (149°C)
AUTOClave OR STERILIZE	temperature limit of 300°F (149°C)	temperature limit of 300°F (149°C)	temperature limit of 300°F (149°C)
OPTIONS			
LIQUID FILLED CASE⁽²⁾			
USP FOOD GRADE GLYCERIN	not available	available	available
FOOD GRADE SILICONE	not available	available	available
PLUS! PERFORMANCE	not available	available	available
NEOBEE-M20 (SYSTEM FILL)	not available	available	available
SHATTERPROOF GLASS WINDOW	available	available	available
POLYCARBONATE WINDOW	available	standard	standard
POLYSULFONE WINDOW	not available	available (needed for autoclave or sterilization)	available (needed for autoclave or sterilization)
1½" CHERRY BURRELL GH LINE CONNECTION	not available	available	available
1½" or 2" CHERRY BURRELL I LINE CONNECTION	not available	available	available
CONNECTION AT 3:00	available	available	available
CONNECTION AT 9:00	available	available	available
SERIAL NUMBER OR SERVICE MARKING ON DIAL	available	available	available
TAGGING OF INSTRUMENT WITH STAINLESS STEEL TAG (WIRED)	available	available	available
EXTERNAL ZERO ADJUSTMENT, TAMPERPROOF DESIGN	not available	not available	available
ZERO & SPAN ADJUSTMENTS	not available	standard	standard (includes external zero adjust)

(1) Compliance to sanitary standard 74-00.

(2) It is recommended that the gauge case be drained of fill liquid prior to autoclave or sterilization.

(3) Gasket material and clamp torque tightness may effect gauge accuracy.

(4) Available on 3½" dial size only.

The fractional 2" sanitary pressure gauge is calibrated at the factory using a Buna N gasket tightened to 25 inch pounds as recommended by Tri-Clover Inc. If the Buna N gasket will not be used, please specify gasket material.



Standard Pressures Ranges

Pressure			
psi	Figure int.		Minor grad.
0/15	1		0.2
0/30	5		0.5
0/60	5		1
0/100	10		1
0/160	20		2
0/200	20		2
0/300	30		5
0/400	50		5
0/600	50		10
0/800	100		10
0/1000*	100		10

Compound				
	Figure int.		Minor grad.	
	in. Hg	psi	in. Hg	psi
30" Hg/15 psi	5	3	1	0.5
30" Hg/30 psi	10	5	1	1
30" Hg/60 psi	10	10	2	1
30" Hg/100 psi	10	10	2	1

*Requires high pressure type clamp.

Metric Pressure Ranges

Pressure							
kg/cm ² (kilograms per sq. centimeter)	bar	Figure interval	Minor graduation	kPa (kilopascal)	Figure interval	Minor graduation	psi outer scale of dual range*
0/1	0/1	0.1	0.01	0/100	10	1	0/14
0/1.6	0/1.6	0.2	0.02	0/160	20	2	0/22
0/2.5	0/2.5	0.5	0.05	0/250	50	5	0/35
0/4	0/4	0.5	0.05	0/400	50	5	0/55
0/6	0/6	0.5	0.1	0/600	50	10	0/85
0/10	0/10	1	0.1	0/1000	100	10	0/140
0/16	0/16	2	0.2	0/1600	200	20	0/220
0/25	0/25	5	0.5	0/2500	500	50	0/350
0/40	0/40	5	0.5	0/4000	500	50	0/550
0/60	0/60	5	1	0/6000	500	100	0/850

Vacuum							
-1/0	-1/0	0.1	0.01	-100/0	10	1	30" Hg

Compound							
-1/0/1.5	-1/0/1.5	0.05	0.05	-100/0/150	50	5	30" Hg/0/20
-1/0/3	-1/0/3	0.05	0.05	-100/0/300	50	5	30" Hg/0/40
-1/0/5	-1/0/5	0.5	0.1	-100/0/500	50	10	30" Hg/0/70
-1/0/9	-1/0/9	1	0.1	-100/0/900	100	10	30" Hg/0/125

Typical Product Coding

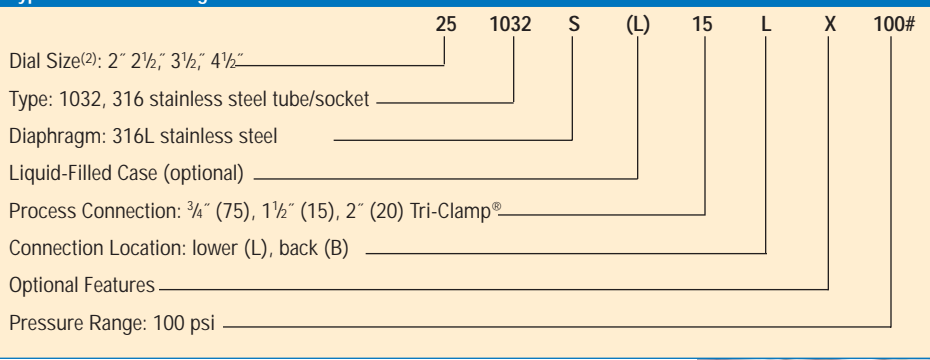

Pressure/Temperature Ratings: Ashcroft Type 1032 sanitary gauge can be produced in many pressure ranges. The limitations of pressure and temperature are based on the actual type of clamp and gasket used. We suggest you consult Tri-Clover, Inc., Kenosha, WI for this information.

® Tri-Clamp is a registered trademark of Tri-Clover, Inc.

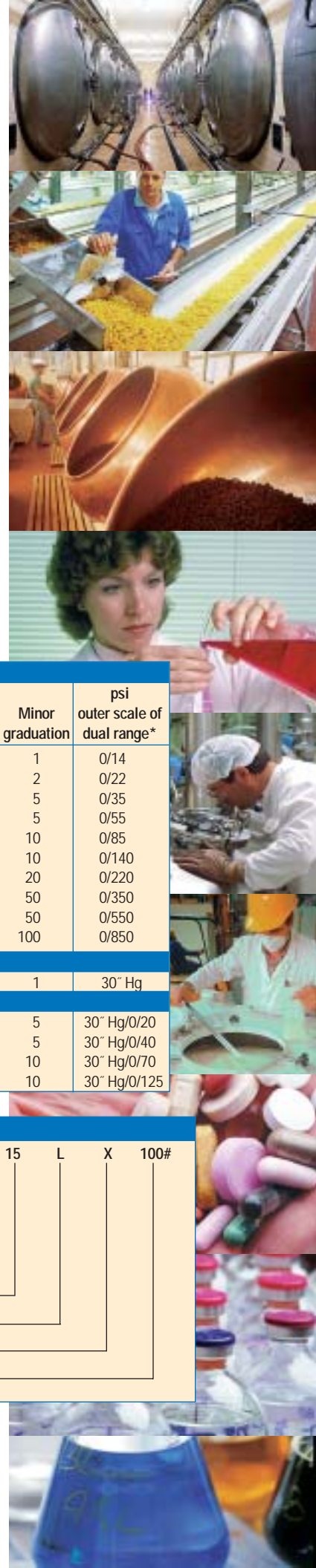

4½"
1.5% F.S. for pressure ranges 100 psi and above. 2.0% F.S. for vacuum, compound and ranges below 100 psi
300 series stainless steel
bayonet, removable
316 stainless steel
316L stainless steel
12 to 20RA
2" Tri-Clamp only
lower or back
glycerin
glass
black painted aluminum. adjustable
white with black markings
400 series stainless steel
3A compliance ⁽¹⁾
temperature limit of 300°F (149°C)
temperature limit of 300°F (149°C)
available
available
available
available
available
not available
available
available (2" only)
available
available
available
available
not available
standard

Instrument Operations, Sales and Customer Service Locations

Type 1032 Case Dimension Drawings

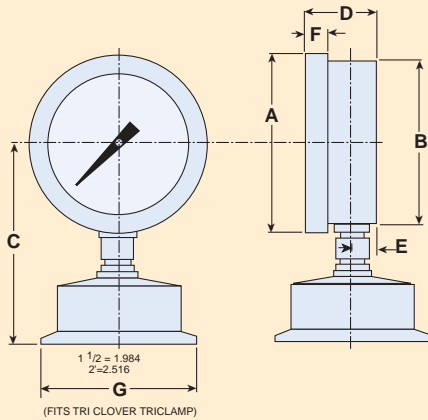

Dial Size	A	B	C	D	E	F	G	
							1/2	2
2 1/2" mm	27/8 (73)	2 21/32 (67)	3 1/16 (78)	1 5/32 (29)	1 3/32 (10)	1 3/32 (10)	2 (51)	2.5 (64)
3 1/2" mm	3 31/32 (101)	3 19/32 (91)	3 9/16 (90)	1 7/32 (31)	1 3/32 (10)	1 5/32 (12)	2 (51)	2.5 (64)
4 1/2" mm	5 3/16 (132)	4 9/16 (116)	4 15/32 (113)	2 1/16 (52)	1 5/16 (24)	1 5/32 (12)	2 (51)	2.5 (64)

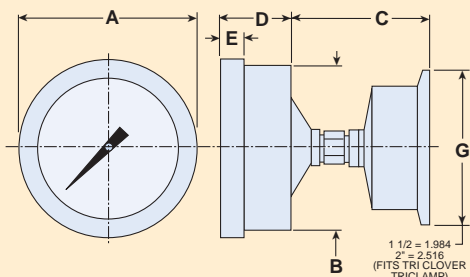

Dial Size	A	B	C	D	E	G	
						1/2	2
2 1/2" mm	27/8 (73)	2 21/32 (67)	2 (51)	1 3/16 (30)	1 3/32 (10)	2 (51)	2.5 (64)
3 1/2" mm	3 31/32 (101)	3 19/32 (91)	2 (51)	1 3/16 (30)	1 5/32 (12)	2 (51)	2.5 (64)

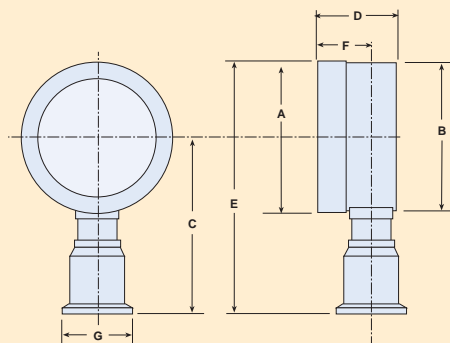

Dial Size	A	B	C	D	E	F	G
2" mm	2 3/32 (53)	2 1/32 (52)	2 7/16 (62)	1 1/16 (27)	3 27/32 (98)	1 1/16 (18)	1 (25)

U.S. & International Headquarters

Stratford, Connecticut
250 E. Main Street
Stratford, CT 06614-5145
Tel: (203) 378-8281
Fax: (203) 385-0357

U.S. Operations

Midwest Region
400 W. Lake St., Suite 318
Roselle, IL 60172-3573
Tel: (630) 980-9030
Fax: (630) 980-9440

Southwest Region
605 Bel Air Blvd., Suite 10
Mobile, AL 36606
Tel: (251) 473-1692
Fax: (251) 473-1782

Southeast Region
605 Bel Air Blvd., Suite 10
Mobile, AL 36606
Tel: (251) 473-1692
Fax: (251) 473-1782

Northeast Region
250 E. Main Street
Stratford, CT 06614-5145
Tel: (203) 385-0670
Fax: (203) 385-0756

Pacific Region
250 E. Main Street
Stratford, CT 06614-5145
Tel: (203) 385-0399
Fax: (203) 385-0402

International Operations

Brazil
Dresser Industria e Comercio Ltda.
Rua Senador Vergueiro #433
09521-320 Sao Caetano do Sul
Sao Paulo, Brazil
Tel: 55-11-4224-7400
Fax: 55-11-4224-7477
E-Mail: vendas.instrumentos@dresser.com

Brazil (Jacarei)
Dresser Industria e Comercio Ltda.
Divisao Masonellan
Rua Particular - Estrada Velha Rio De Janeiro -
Sao Paulo, KM 101 Jacarei,
Sao Paulo Caixa
Postal 167, CEP 12305-330
Tel: 55-11-3958-2011
Fax: 55-11-3958-2670
E-Mail: dresserjac@uol.com.br

Canada

Dresser Canada, Inc.
2135 Meadowpine Blvd.
Mississauga,
Ontario L5N 6L5 Canada
Tel: 905-826-8411
Fax: 905-826-9106
E-Mail: Lance_Barette@dresser.com

China

Dresser Industries, Inc.
Room #2404, Capital Mansion
No. 6 Xin Yuan Nan Road Beijing,
People's Republic of China
100004
Tel: 86-10-84862440/1/2/3/4
Fax: 86-10-84862445
E-Mail: dresser@public3.bta.net.cn

France

Dresser Europe GmbH
206, Rue des Campanules Le
Mandinet
F 77185 Lognes, France
Tel: (33-1-60372530
Fax: 33-1-60372539
E-Mail: europe@wanadoo.fr

Germany

Dresser Europe GmbH
Postfach 11 20 Max-Planck-Str. 1
D-52499 Baesweiler, Germany
Tel: 49-24-01-8080
Fax: 49-24-01-7027
E-Mail: jbiermans@dresserbae.de

Germany

Ebro Electronic GmbH
Peringerstr 10D-85055
Ingolstadt, Germany
Tel: 49-84-1-95478-0
Fax: 49-84-1-95478-80
E-Mail: info@ebro.de

Japan

Dresser Japan Ltd.
Room 818, Shin Tokyo Building
3-1 Marunouchi 3-Chome,
Chiyoda-ku, Tokyo, Japan
Tel: 813-3201-1501
Fax: 813-3213-6567
E-Mail: yuichi.yamamoto@dresserjapan.co.jp

Korea

Dresser International, S.A
#2015 Kuk Dong Bldg.
60-1, 3-KA, Choongmu-Ro,
Chung-ku, Seoul, Korea 100-705
Tel: 82-2-2274-0792
Fax: 82-2-2274-0794
E-Mail: dkisjlee@chollian.net

Mexico

Dresser Instruments S.A. De C.V.
Mexico Operations
Henry Ford No. 114
Esq. Foulton Fracc.
Industrial San Nicolas
54030 Tlalpanantla,
Edo De Mexico
Tel: (52)55-53-10-72-17
(52)55-53-10-89-83
(52)55-53-10-28-29
(52)55-53-10-28-75
Fax: (52)55-53-10-26-08
E-Mail: mendiet@avantel.net

Saudi Arabia

Dresser Al Rushaid Valve &
Instrument Co. (DARVICO)
P.O. Box 10145
Jubail Industrial City
Saudi Arabia 31961
Tel: 966-3-341-0278
Fax: 966-3-341-7624
E-Mail: bill_dumasia@darvico.com
E-Mail: sam_dastur@darvico.com

Singapore

Dresser Singapore
Instrument Operations
Block 1004 Toa Payoh North
#07-15/17 Singapore 318995
Tel: 65-6252-6602
Fax: 65-6252-6603
E-Mail: john.wong@dresser.com.sg

United Kingdom

Dresser Europe GmbH
East Gillibrands, Skelmersdale
Lancashire, WN8 9TU
United Kingdom
Tel: 14-16-95-52600
Fax: 14-16-95-52693
E-Mail: Johanna.Gribben@dresser-instrument.co.uk
E-Mail: sales@dresser-instrument.co.uk

Venezuela

Manufactures Petroleras
Venezolanas (M.P.V.)
KM 7 Carretera A El Mojan Calle 18,
#15B355 ZONA Ind. Norte Sector
Canchancha Maracaibo Edo
Zulia Venezuela
Tel: 58-61-579-762/070
Fax: 58-61-579-461
E-Mail: contactenos@mapvensa.com
E-Mail: ventasmpv@telcel.net.ve



Visit our web site www.ashcroft.com

All specifications are subject to change without notice.
All sales subject to standard terms and conditions.
© Dresser, Inc., 6/96 20M CP 5P 7/02